

Remove & Replace the Tooling Plate (Table)

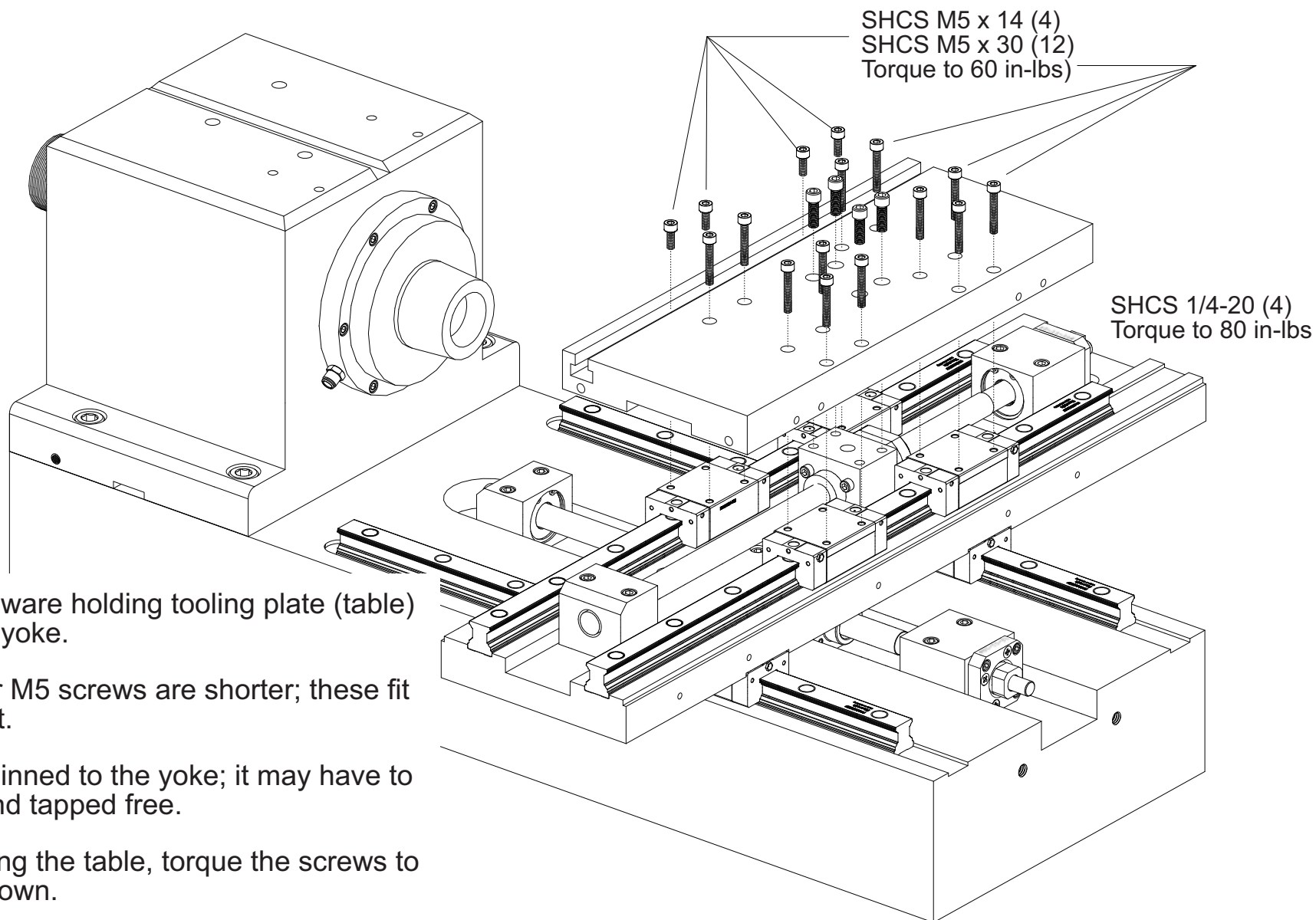

Remove & Replace X-axis Rails

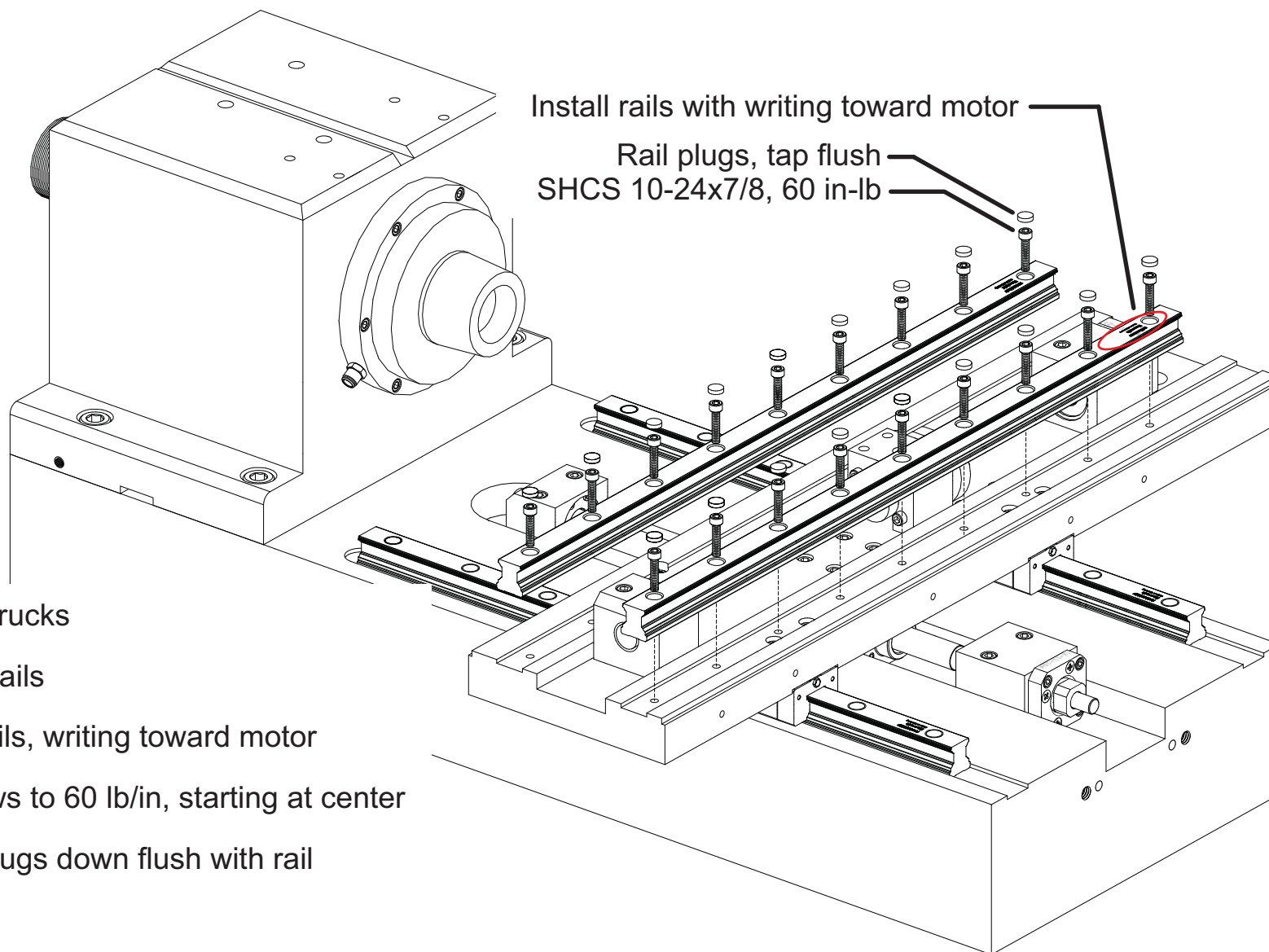

Remove old trucks

Remove old rails

Install new rails, writing toward motor

Tighten screws to 60 lb/in, starting at center

Tap the rail plugs down flush with rail

Replace X-axis Trucks

Carefully slide new trucks onto new rails with ground surfaces facing out (writing facing in).

As you push each truck onto the rail, the plastic retainer will slide out the opposite end of the truck.

Locate lube fittings as shown to facilitate lubrication when necessary. (Trucks are pre-lubed).

Lubrication: The linear guide manufacturer recommends charging the bearing blocks with lithium grease every 4,000,000 inches of travel.

A “needle tip” is required to fit the fitting on the blocks. Tips are available from Napa (pn 715-1215) or MSC (pn 48527378). McMaster offers an a zerk-compatible adapter, 2906K52.

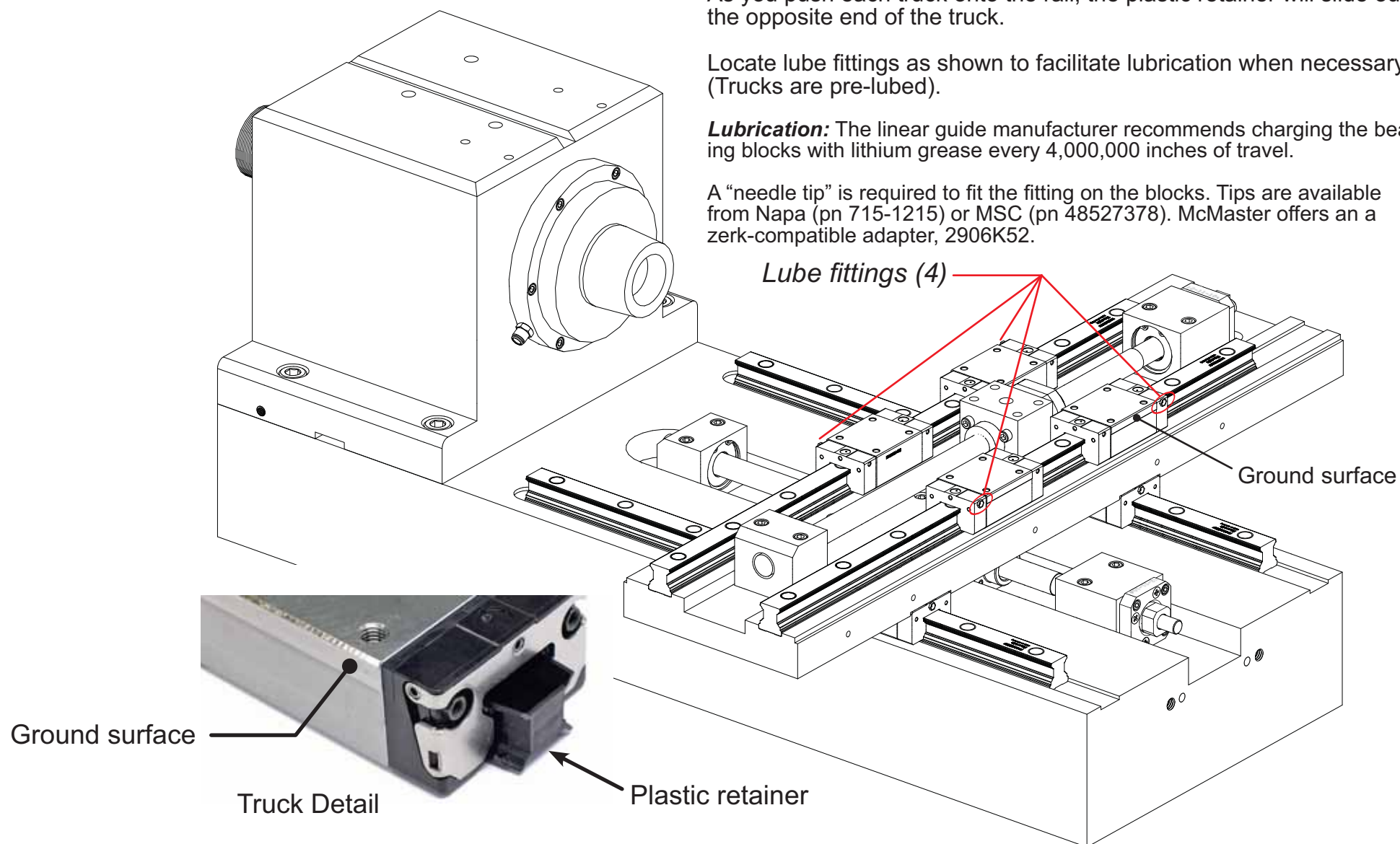

Remove & Replace the Saddle

Note: X-axis rails must be removed to remove saddle

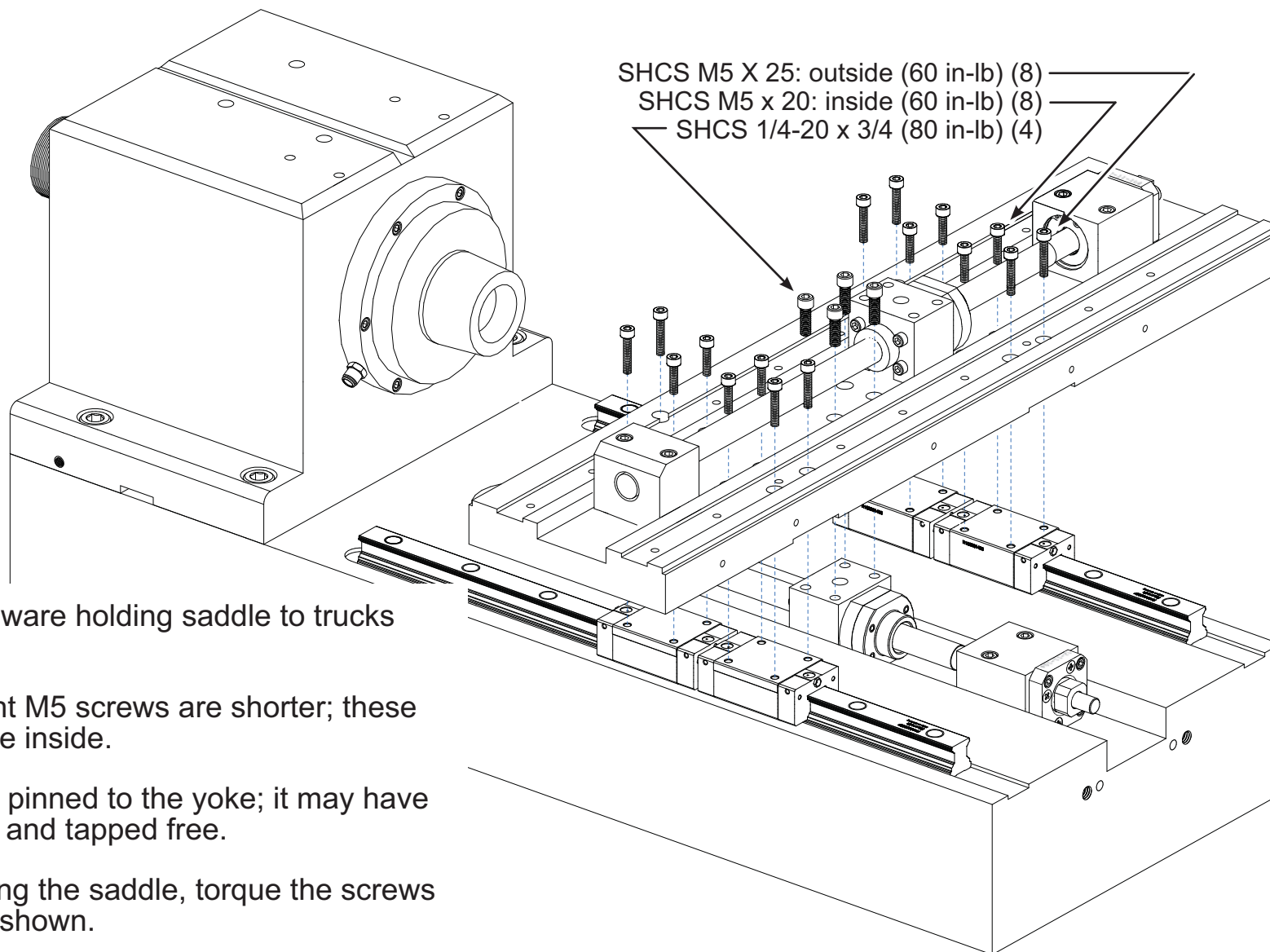

Remove hardware holding saddle to trucks and yoke.

Note that eight M5 screws are shorter; these fit holes on the inside.

The saddle is pinned to the yoke; it may have to be wiggled and tapped free.

When replacing the saddle, torque the screws to the values shown.

Remove & Replace Z-axis Rails

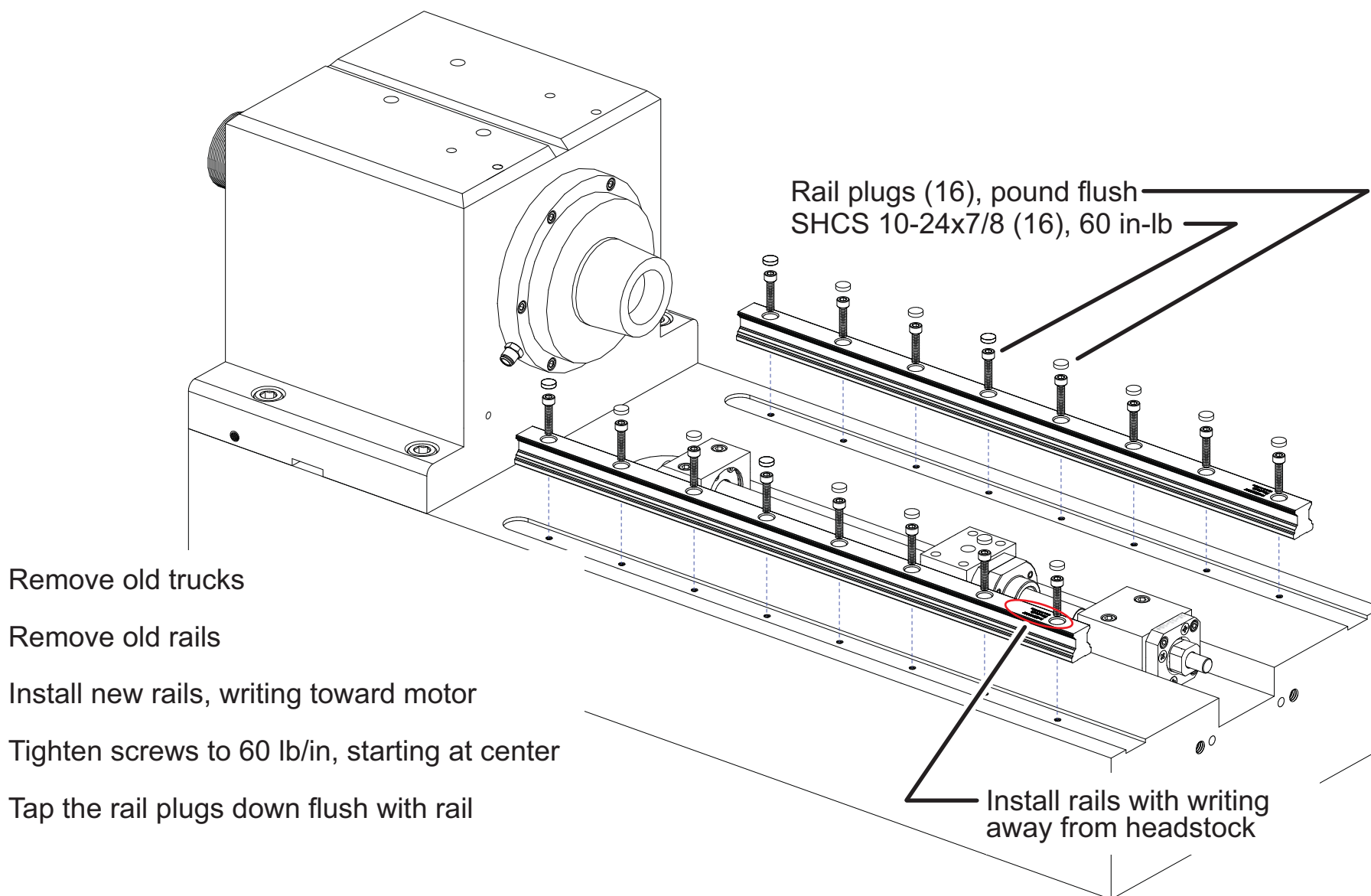

Replace Z-axis Trucks

Carefully slide new trucks onto new rails with ground surfaces facing out (writing facing in).

As you push each truck onto the rail, the plastic retainer will slide out the opposite end of the truck.

Locate lube fittings as shown to facilitate lubrication when necessary. (Trucks are pre-lubed).

Lubrication: The linear guide manufacturer recommends charging the bearing blocks with lithium grease every 4,000,000 inches of travel.

A “needle tip” is required to fit the fitting on the blocks. Tips are available from Napa (pn 715-1215) or MSC (pn 48527378). McMaster offers an a zerk-compatible adapter, 2906K52.

